

Product Datasheet

Wall mounted unheated safety shower

23GH
23GSH

Suited to numerous indoor applications, this wall mounted emergency safety shower is perfect where space is at a premium. Designed to meet ANSI standards the safety shower will deliver 76 liters (20 US gal) of water per minute to drench the casualty in the event of an emergency requiring decontamination.



Specifications

MATERIALS OF CONSTRUCTION	
PIPEWORK & FITTINGS	Stainless steel (GS) or galvanized mild steel (G)
OPERATING VALVE	Stainless steel, full bore, stay open ball valve
SHOWER NOZZLE	Injection moulded nylon 6
SERVICES	
WATER INLET	1" female NPT
OPERATING PRESSURE	2 to 6 BAR G / 29 to 87 PSI (higher supply pressures accommodated with the incorporation of the optional pressure reducing valve)
MINIMUM FLOW RATES	76 L per minute / 20 US gal per minute
AMBIENT OPERATING TEMPERATURE	
MINIMUM	5C / 41F
MAXIMUM	35C / 95F
OPERATION	
SHOWER/BODY SPRAY	Pull handle
DIMENSIONS & WEIGHT	
DIMENSIONS (WxDxH)	150mm (5.9in) x 645mm (25.4in) x 719mm (28.3in)
WEIGHT	5kg (11lb)

General Arrangement Drawing

Wall mounted unheated safety shower

23GH
23GSH

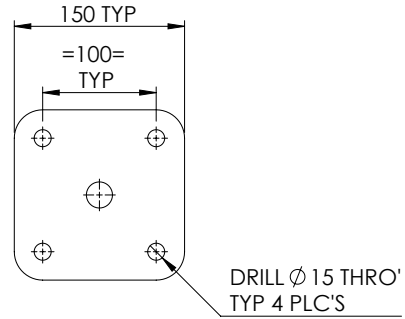
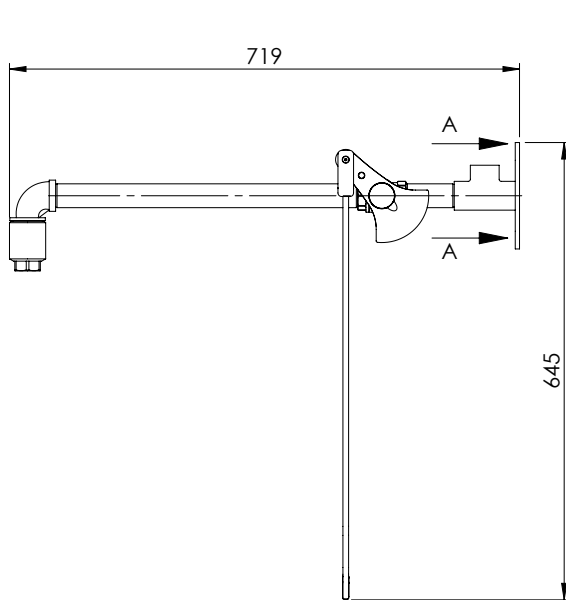

VIEW ON A-A
(MOUNTING DETAILS)
SCALE 1:5

